

HBNC ECONOMIC BIG BORE CARTRIDGE SEAL

- ECONOMIC CARTRIDGE DESIGN
- COMPACT BUT STURDY CONSTRUCTION
- MINIMUM NUMBER OF COMPONENTS
- UNIQUE DRIVE LUGS ARRANGEMENT
- FITS ON ANSI LARGE BORE STUFFING BOXES
- EASY TO INSTALL

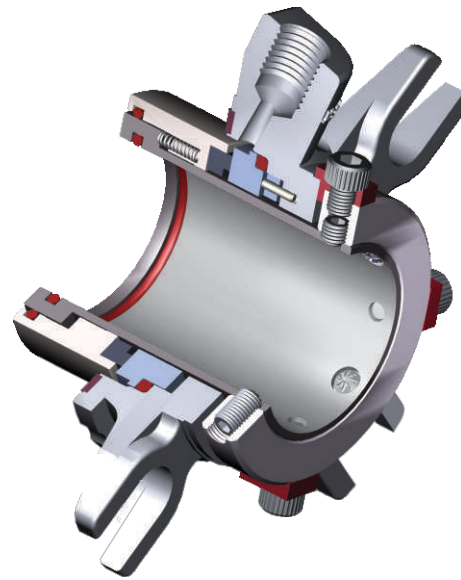

APPLICATIONS :

- PULP & PAPER
- MODERATE SLURRIES
- CRYSTALLISING SOLUTIONS
- ALL PROCESS PUMPS
- STERILE APPLICATIONS

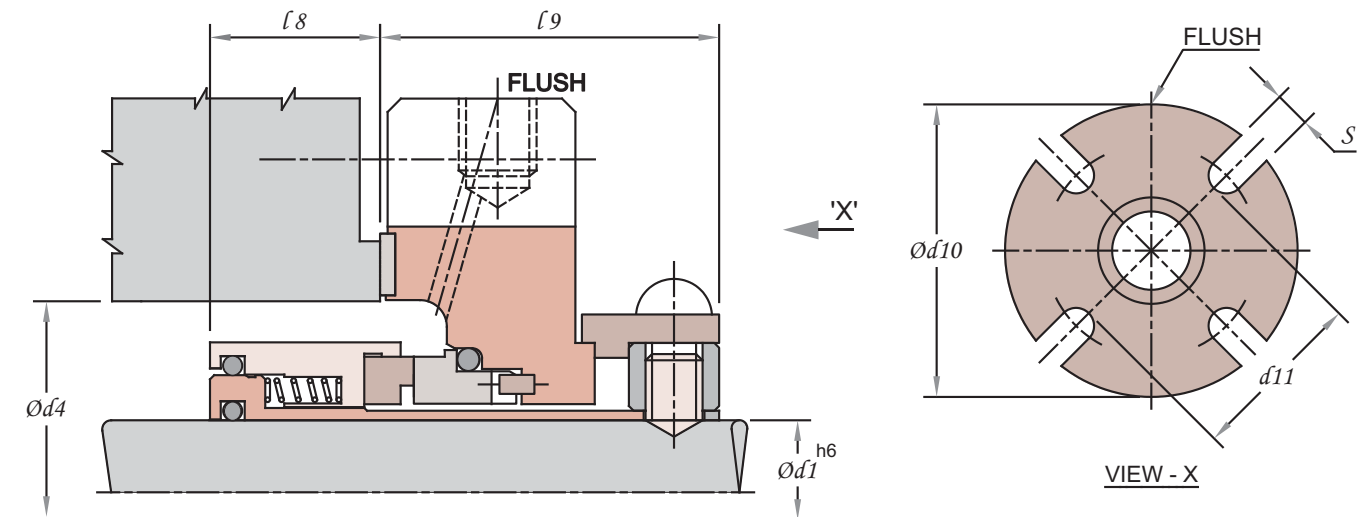

INCHES SIZES

SEAL CODE	d1	min. d4	max. d4	d10	d11	l8	l9	SLOT WIDTH S
0285	28.57	66.67	69.85	124.50	78.94	19.9	37.1	14.0
0349	34.92	69.21	76.20	133.35	90.11	21.9	37.1	14.0
0444	44.45	88.90	95.25	165.10	110.97	21.9	37.1	14.0
0476	47.62	92.07	98.42	147.00	105.51	21.4	37.1	14.0
0596	53.97	98.55	101.6	184.15	117.39	26.4	37.1	18.0
0635	63.50	114.3	127.0	209.55	139.62	26.4	41.2	18.0
0667	66.67	117.47	120.65	203.20	130.09	31.2	41.2	18.0
0762	76.20	123.82	130.17	209.55	142.79	30.7	45.0	18.0

ALL DIMENSIONS IN MM

METRIC SIZES

SEAL CODE	d1	min. d4	max. d4	d10	d11	l8	l9	SLOT WIDTH S
0280	28.00	66.67	69.85	124.50	78.94	19.9	37.1	14.0
0350	35.00	69.21	76.20	133.35	90.11	21.9	37.1	14.0
0450	45.00	88.90	95.25	165.10	110.97	21.9	37.1	14.0
0480	48.00	92.07	98.42	147.00	105.51	21.4	37.1	14.0
0530	53.00	98.55	101.6	184.15	117.39	26.4	37.1	18.0
0630	63.00	114.3	127.0	209.55	139.62	26.4	41.2	18.0
0650	65.00	117.47	120.65	203.20	130.09	31.2	41.2	18.0
0750	75.00	123.82	130.17	209.55	142.79	30.7	45.0	18.0

DIMENSIONS FOR HIGHER SIZES AVAILABLE ON REQUEST

DESIGN VARIATIONS

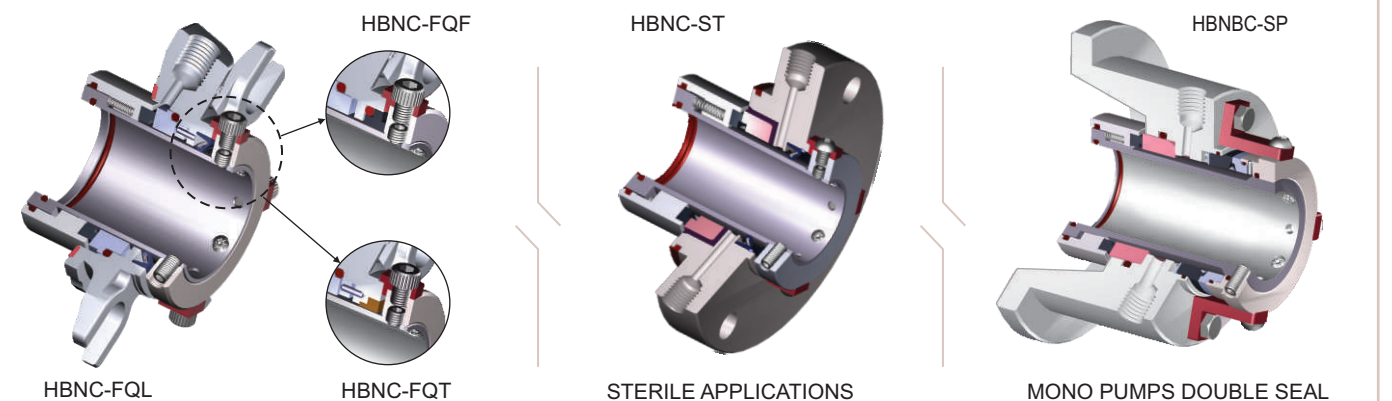

LIMITING PARAMETERS

PRESSURE	TEMPERATURE	SPEED
UPTO 16 BAR	- 40°C TO 280°C DEPENDING UPON ELASTOMER	26 m/sec

MATERIALS

METAL PARTS	FACE COMBINATIONS	ELASTOMERS
SS316 ALLOY-20 HAST-C	ROTARY SiC, TC	VITON, NITRILE, PTFE NEOPRENE, EPR, FFKM AFLAS, STV, SILICON
	STATIONARY CARBON	
	SiC	SiC, TC
	TC	SiC, TC