

SCSC UNIVERSAL BIG BORE CARTRIDGE SEAL

- HEAVY DUTY CONSTRUCTION
- REPLACES CONVENTIONAL DOUBLE SEALS
- NON CLOGGING, SPRING PROTECTED
- CAN TOLERATE PRESSURE REVERSAL
- STATIONARY SPRING DESIGN
- GUIDED QUENCH & DRAIN
- FITS ON ANSI BIG BORE & API PUMPS

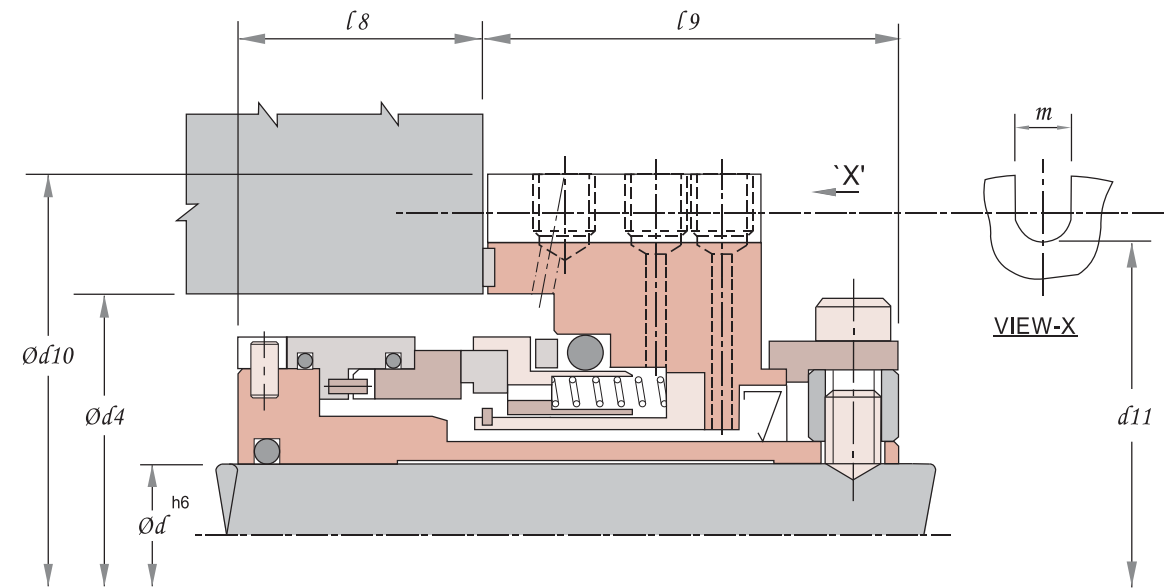
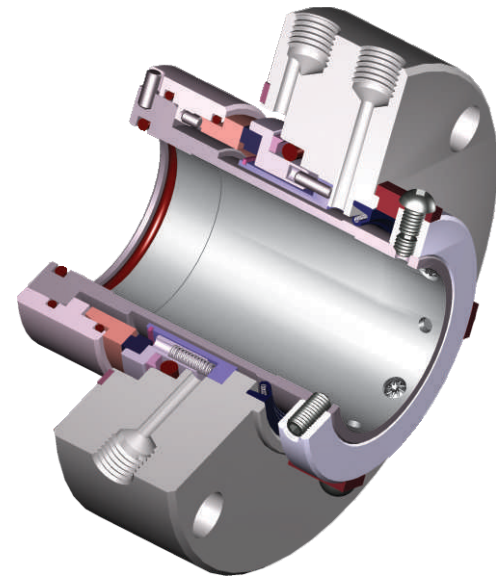

APPLICATIONS :

- VACUUM DISTILLATION
- SLURRIES
- SALT SOLUTIONS
- BIG BORE PUMPS
- PROCESSING EQUIPMENTS

INCH SIZES

SEAL CODE	SHAFT / SLEEVE DIA 'd'	min. d4	max. d4	d10	d11	l8	l9	m
0285 (0127)	12.70	49.0	57.00	105.00	67.00	34.0	52.0	11.5
0317 (0190)	19.05	55.4	60.25	110.00	70.00	34.0	52.0	11.5
0349 (0222)	22.22	58.5	63.45	115.00	73.00	34.0	52.0	11.5
0381 (0254)	25.40	61.7	66.65	118.00	76.00	34.0	52.0	11.5
0412 (0285)	28.57	64.9	69.85	124.50	78.94	34.0	52.0	11.5
0444 (0317)	31.75	68.4	71.58	128.00	82.00	31.0	52.0	11.5
0476 (0349)	34.92	71.3	76.20	133.35	90.12	34.0	52.0	11.5
0508 (0381)	38.10	74.4	77.60	138.00	92.00	34.0	52.0	13.5
0539 (0412)	41.27	77.6	80.80	143.00	96.00	34.0	52.0	13.5
0571 (0444)	44.45	80.8	95.25	165.10	110.97	35.5	52.0	13.5
0603 (0476)	47.62	84.0	98.42	165.10	105.51	35.5	52.0	13.5
0635 (0508)	50.80	87.1	96.00	170.00	108.00	35.5	52.0	13.5
0666 (0539)	53.97	90.3	101.60	184.15	117.40	37.0	54.6	17.5
0698 (0571)	57.15	93.5	107.00	191.00	121.00	37.0	54.6	17.5
0730 (0603)	60.32	96.7	113.00	196.00	125.00	37.0	54.6	17.5
0762 (0635)	63.50	100.2	127.00	209.55	139.62	37.0	54.6	17.5
0825 (0666)	66.67	108.7	120.65	203.20	130.09	37.0	54.6	17.5
0952 (0762)	76.20	122.2	130.17	209.55	142.79	37.0	54.6	17.5

DIMENSIONS FOR HIGHER SIZES AVAILABLE ON REQUEST

ALL DIMENSIONS IN MM

LIMITING PARAMETERS

PRESSURE UPTO 25 BAR	TEMPERATURE - 40°C TO 280°C DEPENDING UPON ELASTOMER	SPEED 26 m/sec
--------------------------------	---	--------------------------

MATERIALS

METAL PARTS SS316 ALLOY-20 HAST-C	FACE COMBINATIONS		ELASTOMERS VITON, NITRILE, PTFE NEOPRENE, EPR, FFKM FEP, STV, AFLAS
	ROTARY	STATIONARY	
	SiC, TC	CARBON	
	SIC	SIC, TC	
	TC	TC	

